

Home mobility

HL100

Product Catalogue



thyssenkrupp





Content

004

Product Summary

006

Platform

014

Door

023

Shaft

026

Communication

027

Drive

028

FAQ

030

Features and Benefits

033

Drawings

HL100 Compact - Product summary



Compact - the smallest home lift

The smallest and most compact home lift in our product range and on the market. The lift has been designed to meet all requirements for comfort, space and design in narrow environments. The lift is available in different sizes, with an option to personalize it with details such as glass walls, a range of varied colours and different materials.

HL100 Compact

Technical compliance:	European Machine directive 2006/42/EC European standard EN 81-41
Drive system:	Screw/nut system
Rated speed:	Max. 0,15 m/s
Rated Load:	250 kg
Travel height:	1400 - 12000 mm
Distance between intermediate floor:	min. 250 mm
Number of stops:	Max. 6 stops per lift
Number of doors:	Max. 6 doors per lift
Number of doors per floor:	Max. 1 doors per floor
Pit:	50 mm (no pit is required when there is a threshold/ramp)
Shaft Top height:	Standard 2430 mm (elongation is possible)
Platform control:	"Hold to run"
Landing control (on door):	One-touch call
Environment:	Indoor
Emergency lowering:	Battery operated emergency lowering
Control voltage:	24V
Motor:	1,5kW
Power requirements:	1-phase 230Vac 50/60Hz - Max Power 3 kW
Circuit Breaker / RCD	16A Tripping curves C / 30mA class A or B

It works with standard 230 V single phase.
It does not need 400 V triple phase.

Platform

HL100 Compact is available in 3 different platform sizes.
The Platform is Full Height Panel
The rated load is 250 kg and the power supply needed is 230 V 1-phase.

Platform size B-side x A/C-side (mm)	Max load (kg)
800 x 580	250
800 x 840	250
800 x 1100	250

HL100 Mobility - Product summary



Mobility - our accessible home lift

Designed to meet all requirements for quality, safety and service life. The lift is available in several different sizes up to 1400x1100. It is a perfect fit for tough and demanding environments such as schools, public and residential buildings.

HL100 Mobility

Technical compliance:	European Machine directive 2006/42/EC European standard EN 81-41
Drive system:	Screw/nut system
Rated speed:	Max. 0,15 m/s (depending on effective load)
Rated load:	325 or 400 kg (depending on platform size)
Travel height:	1400 - 12000 mm
Distance between intermediate floor:	min. 250 mm
Number of stops:	Max. 6 stops per lift
Number of doors:	Max. 12 doors per lift
Number of doors per floor:	Max. 2 doors per floor
Pit:	50 mm (no pit is required when there is a threshold/ramp)
Shaft Top height:	Standard 2430 mm (elongation is possible)
Platform control:	"Hold to run"
Landing control (on door):	One-touch call
Environment:	Indoor
Emergency lowering:	Battery operated emergency lowering.
Control voltage:	24V
Motor:	2,2kW
Power requirements:	1-phase 230Vac 50/60Hz - Max Power 4,5 kW
Circuit Breaker / RCD	16A Tripping curves C / 30mA class A or B

It works with standard 230 V single phase.
It does not need for 400 V triple phase.

Platform

HL100 Mobility is available in 3 different platform sizes.
The platform is Full Height Panel with Roof.
The rated load depends on the platform size and the power supply needed is 230 V 1-phase.

Power Management System (PMS)

The lift, unique of its kind, is designed to optimize the power consumption according to the load conditions. When requested, the lift controller will adjust the upwards speed to keep the consumption always below the contractual power installed in the building, either it is 3 kW or 4,5 kW.

Platform size B-side x A/C-side (mm)	Max load (kg)
1400 x 900	325
1400 x 1000	325
1400 x 1100	400

Platform



Platform - Compact



Full height panel

The platform is delivered with a side wall (full height) including the control operation panel and the handrail. It comes with LED lightening as standard.

The side wall is Skinplate A4, but can be as an option

- executed in other skinplate finishes
- made in Stainless Steel
- painted in any RAL colour

Available for HL100 Compact only.

Width: 800 mm

Height: 2200 mm.

Mirror

A mirror can be ordered as an option.

Control Panel & Handrail

Control Panel is black mirror and comes with white LED backlight.

Handrail is Black standard and can be order as option in Stainless Steel.

Telephone

Platform

Provided with vynil floor and safety edges.

A,B,C and G-side of platform.

Platform - Mobility

Full height panel with roof

The platform can be delivered with a full height wall (2100 mm high) with a ceiling.

The full height wall is is Skinplate A4, but can be as an option

- executed in other skinplate finishes
- made in Stainless Steel
- painted in any RAL colour

The full height wall is available for G-side of 1400 mm, i.e for platform sizes 1400x900, 1400x1000 and 1400x1100 mm.
Provided with a couple of photocells for each open side.

Fold down seat

In solid transparent plexiglass and with metal like painted brackets.

The seat has to be folded back manually after use.

Can be ordered as an option.

Size: 300 x 420 mm

Rated Load: 100 kg according to EN81-41

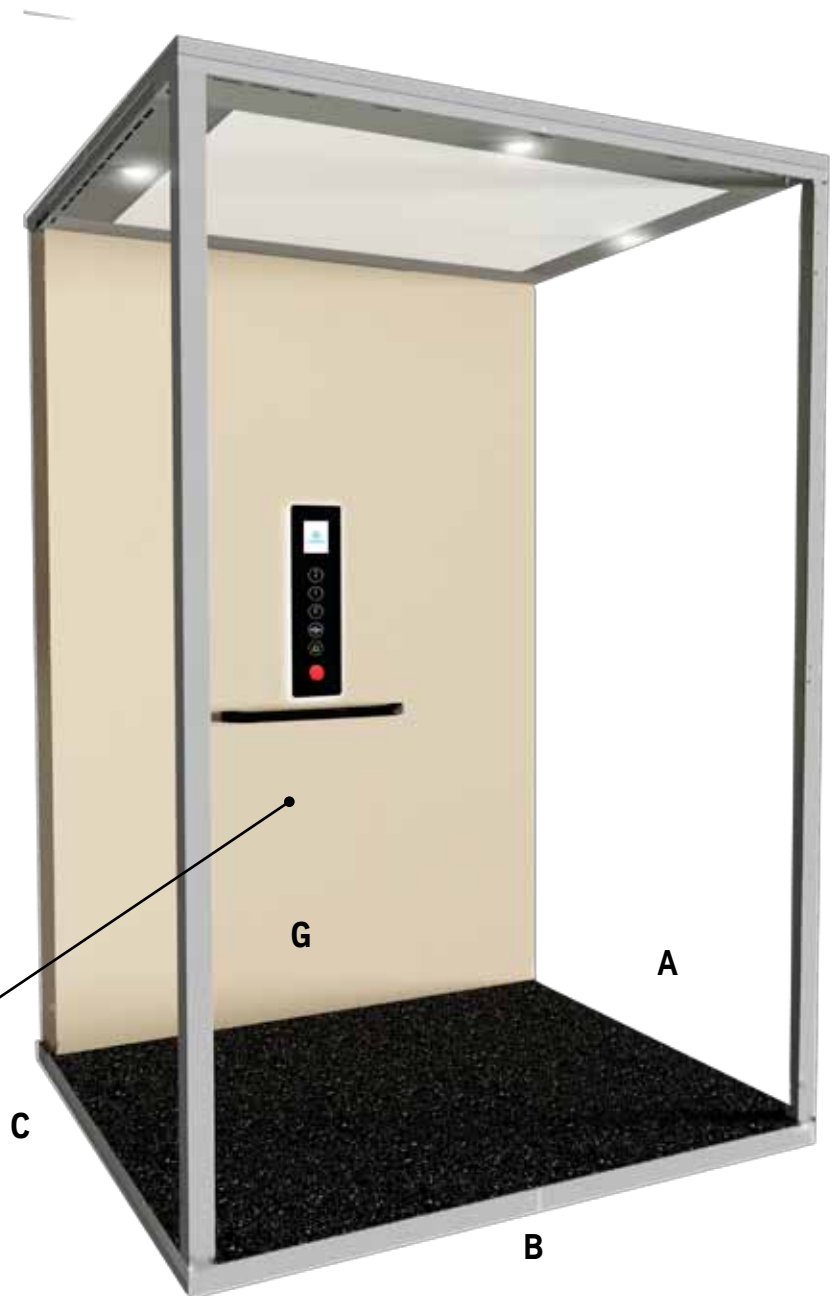

A,B,C and G-side of platform.

Platform - Dimensions

HL100 is available in several different plan sizes.

This overview illustrates the free space at the platform floor, according to relevant code.

For more detailed drawings see the annex.

HL100 Compact

800x580

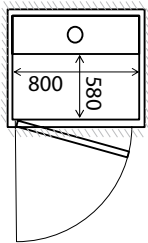

800x840

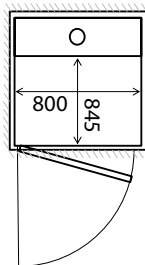

800x1100

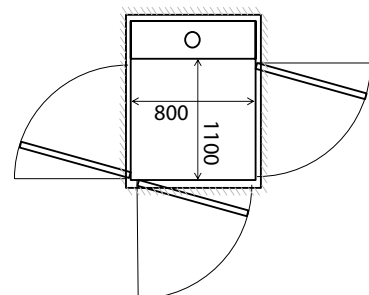

Doors on side A/C are possible for 800x1100 plan.

For adjacent accesses (A/B or B/C sides) minimum distance between floors is 2300 mm.

For opposite accesses (A/C sides) minimum distance between intermediate floors is 250 mm.

HL100 Mobility

1400x900

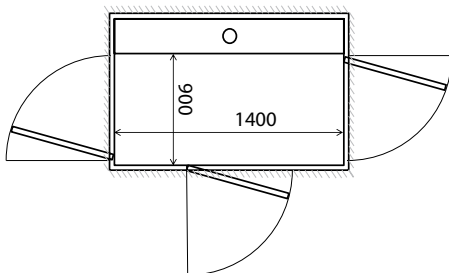

1400x1000

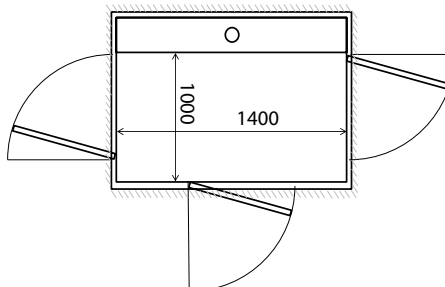

1400x1100

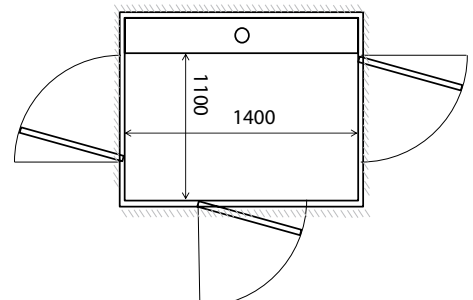

Platform - main features

Control Operation Panel

The control panel is always placed on the machine side (G-side) of the platform. It contains the destination buttons, the emergency stop and the alarm button.

It can contain as option an autodialer, a key switch and a [TFT display](#) with landing indicator and voice announcer.

It is provided always with [backlight all around the profile](#) which emphasizes the design of the panel.

The location of the platform buttons and the handrail are according to EN 81-41

Destination buttons

Destination buttons are according to EN 81-41. The location of the buttons are within the limits in the standard, i.e. height between platform floor and the center line of the buttons is between 900-1100 mm.

Standard buttons are engraved with braille.

Diameter for buttons in Vertical Panel: 37 mm

Following buttons are available:

-2, -1, 0, 1, 2, 3, 4, 5, 6, B, BG, BV, G, K, KV, P, U, E.



Alarm button

A standard alarm button is always delivered with the lift.

The alarm button is connected to an external alarm sounder or/and to an optional autodialer.

When it is pressed, a siren sounds. Keep it pressed for 3 seconds to activate the emergency call with the optional autodialer.



Emergency stop button

Red Button for emergency situations. Is always included as standard.

External alarm sounder

Alarm sounder is mounted in the electrical cabinet for Mobility. Alarm sounder is delivered within a box for Compact to be mounted outside the lift.

It is connected to the alarm button and when the alarm button is pressed the siren will give a loud signal outside the lift to attract attention in case of emergency.



Handrail

A handrail is mandatory according to EN81-41 and delivered as a standard in black finish. Height between platform floor and top edge of the gripping part of the handrail is within 875 - 925 mm. Minimum cross-sectional dimension is 30 mm.

Stainless steel (option)

Display and Landing indicator

TFT Colour digital display positioned at the control panel.
It shows which floor the lift is on at the moment.

The landing indicator can also show information from the system.

- Direction of the lift when travelling
- Icons for the different status of the lift
 - A bell when the alarm button has been pressed.
 - A weight symbol if the lift is overloaded.
- Error code for diagnostic
- If connected to the buildings fire alarm a symbol will be shown when alarm is activated.

Can be ordered as an option.

The indicator can also be fitted with a voice announcer available in English, Italian, French, German, Spanish, Dutch, Portuguese, Czech and Russian.

Building Integration

The lift can be connected to the buildings fire alarm.

In case of fire, a symbol on the display will be shown when alarm is activated and the lift will move to a predetermined floor and park.



Key switch on platform

Key switch placed on the control panel. The key switch locks the platform functions and prohibits unauthorized use.

Two options to choose from:

- mechanical key
- i-button

Can be ordered as option. One key switch per platform can be provided. The key switch can be connected to all destination buttons.

We can also design specific configurations for individual access from different users



Platform - finishes

Flooring

Choose between the following options for safety vinyl flooring with guaranteed life time slip.

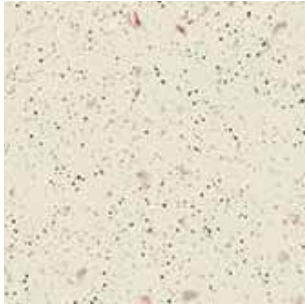

White
Vinyl

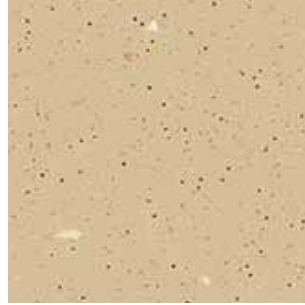

Dune
Vinyl

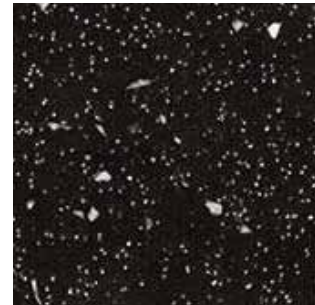

Charcoal
Vinyl

Prepared
for
customer
application

Choose to have your lift delivered without flooring, if you want to apply your own.
Max 3 mm flooring for flush top alignment.

Platform Wall

RAL Colour suggested for painted parts to match with the precoated steel.

PRECOATED STEEL - PLAN

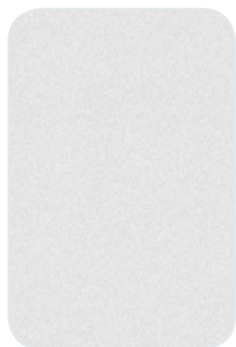

A1 - RAL9003



A4 - RAL9010
(standard)



A13 - RAL1013



B13 - RAL5024



G1 - RAL1015



N1 - RAL7035



PPS - Metal Like
RAL7037

STAINLESS STEEL



Stainless Steel Satin

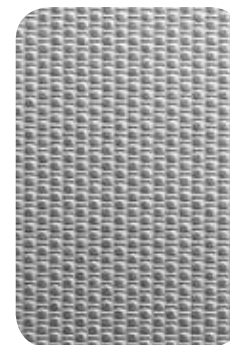

Stainless Steel Linen
(Scratch resistant finish)

PRECOATED STEEL - PPS



PPS1 -RAL 7035



PPS10 - RAL 9003



PPS11 - RAL 1013

RAL PAINTING AT CHOICE



Real colours and layout may differ from those shown. Slight noticeable differences is possible because of different materials.
Contents subject to change without notice

Doors



Door - Compact

General information

The landing doors installed at each landing are made of steel.

Doors can be blind or panoramic.

All doors are painted in RAL 9010 (White) but can be painted in any RAL colour as an option. The door frame is painted in the same colour of the door.

Panoramic doors have a safety glass 10/11 mm thick. Standard is with Transparent glass. Optional: Smokey Grey, Smokey Satin, Opalin or Half Reflecting glass.

The profiles around the glass are made of aluminium. The profiles can be painted in any RAL colour as an option.

All doors are 800 mm and can be left or right hinged.

Doors on side B are without vertical frame to maximize the net opening.

Doors on side A/C are possible for 800x1100 plan size and are always delivered with a frame.



Panoramic door side C

Panoramic door

Door with one glass window.

Opening widths : 800 mm

Opening heights: standard: 2000 mm. Option: 1800, 1900 mm

Glass window: 715x1460 mm fro standard door

Standard:

- Door and door frame in RAL 9010 (White)
- Glass window: Transparent Glass

Options:

- Door and door frame in other RAL colour
- Glass window: Smokey Grey, Smokey Satin, Opalin or Half Reflecting

Door opening width (mm)	Door opening height (mm)	Available for B-side (mm)	Available for A/C side (mm)
800	1800 / 1900 / 2000	800	800



Panoramic door side B

Door frame and actual height

The height of the door frame depends on the door net height and is 140/160 mm higher than the door opening height.

The actual height of the door is 40 mm higher than the net height.

Door net height (mm)	Door actual height (mm)	Frame height side B (mm)	Frame Height side A/C (mm)
1800	1840	1960	1940
1900	1940	2060	2040
2000	2040	2160	2140

Door - Mobility

General information

The landing doors installed at each landing are made of steel. Doors can be blind or panoramic. All doors are painted in RAL 9010 (White) but can be painted in any RAL colour as an option. The door frame is painted in the same colour of the door.

Panoramic doors have a safety glass 10/11 mm thick. Standard is with Transparent glass. Optional: Smokey Grey, Smokey Satin, Opalin or Half Reflecting glass. The profiles around the glass are made of aluminium. The profiles can be painted in any RAL colour as an option.

All doors can be left or right hinged. Doors are always delivered with door frames. It is not possible to order the door or the frame separately.

Panoramic door

Door with one glass window.

Opening widths: 700, 800, 900 mm
Opening heights: 1800, 1900, 2000, 2100 mm
The actual height of the door is 40 mm higher since a plate that covers the joint between the door and the frame is mounted on the door.
Glass window: 470x1600 mm (700 mm wide door)
(vision) 570x1600 mm (800 mm wide door)
670x1600 mm (900 mm wide door)

Standard:

- Door and door frame in RAL 9010 (White)
- Glass window: Transparent

Options:

- Door and door frame in other RAL colour
- Glass window: Smokey Grey, Smokey Satin, Opalin or Half Reflecting.



Door net width (mm)	Door width including frame (mm)	Door net height (mm)	Available for B side (mm)	Available for A/C side (mm)
700	900	1800/1900/2000	1400	900/1000
800	1000	1800/1900/2000	1400	1000/1100
900	1100	1800/1900/2000/2100	1400	1100

Door frame and actual height

The height of the door frame depends on the door net height and is always 140 mm higher than the door opening height. The actual height of the door is 40 mm higher than the net height.

Door net height (mm)	Door actual height (mm)	Frame Height (mm)
1800	1840	1940
1900	1940	2040
2000	2040	2140
2100	2140	2240

Displacement of door on B-side

If it is not possible to fit the door on the B-side in the standard location, it is possible to place the door to the left or to the right limit.

B-Side. Full Wall Ceiling Panel.

Platform size (mm)	Door opening (mm)	Door width including frame (mm)	Standard displacement (mm)	Displaced to the left (mm)	Displaced to the right (mm)
			Left / Right side of door	Left / Right side of door	Left / Right side of door
1400	900	1100	345 / 345	200 / 490	490 / 200

Possible displacement of door on B-side for platform 1400 mm wide.

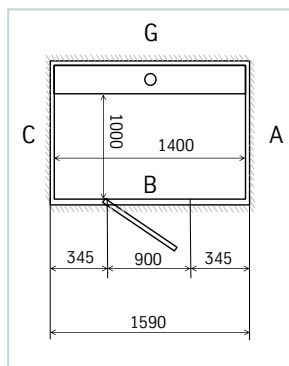

Standard displacement

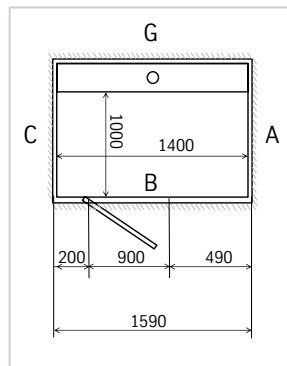

Left limit

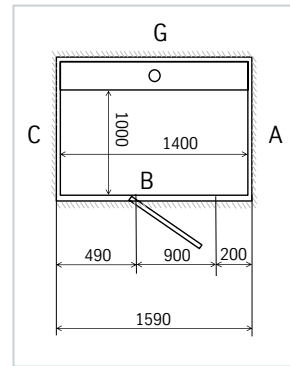

Right limit

Door - Mobility



EI120 – Fire & smoke proof door

Fire & smoke proof doors comply with EN 81-58.

EI doors are blind without any glass window.

EI doors are always delivered with a frame. The size of the frame depends on platform size and the door net width and height. The height of the frame is always 140 mm higher than the door net height. The frame is always 200 mm wider than door opening

Opening width: 700, 800, 900 mm

Opening height: 1900, 2000, 2100 mm

The actual height of the door is 40 mm higher since a plate that covers the joint between the door and the frame is mounted on the door.

Standard:

- Door and door frame in RAL 9010 (White)

Options:

- Door and door frame in other RAL colour

Door net width (mm)	Door width including frame (mm)	Door net height (mm)	Available for B side (mm)	Available for A/C side (mm)
700	900	1800/1900/2000	1400	900/1000
800	1000	1800/1900/2000	1400	1000/1100
900	1100	1800/1900/2000/2100	1400	1100

Door control

The door control is either placed on the door frame of each landing door and/or placed away from the lift as an external control.



Door control on door frame

Door control placed on the door frame on the lift.
For Mobility there is always place on the door frame for a door faceplate.

For Compact there will only be place for a door faceplate on the A and C side

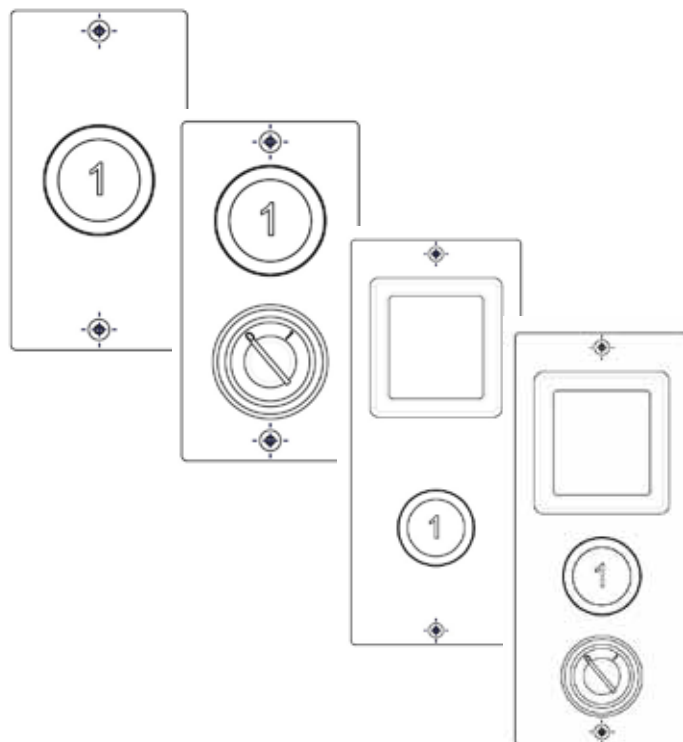

Door faceplate

The door faceplate is in standard Aluminium. As option it can be delivered RAL painted in the same colour of their door.

The door faceplate can hold:

- Call button
- Key switch
- i-button
- LCD display
- Key switch prepared for EUR

Key switch / School locking

Instead of having a normal call button on the door faceplate, a key switch is possible. Then user needs to have the key to be able to call for the lift and to access the lift.

It includes school locking function which automatically locks the door after an adjustable time it is closed.

We can provide one key switch per door only.

Call button

The call button comes with a background lit frame which indicates the status of the lift.

- Green light indicates that the lift is at your floor. Lit only on the floor where the platform is at the moment.
- Red light indicates that the lift is occupied. It is busy and you can't call for it.
- The flashing light indicates that the security circuit is broken, e.g. that the emergency button is pressed, the door is open on another floor for more than one minute, the door is blocked or the safety frame is pressed down. The flashing light can also be activated by a sum alarm, more information is then available in the service memory.

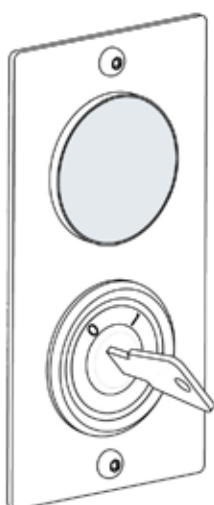

Abilitation & Call Key

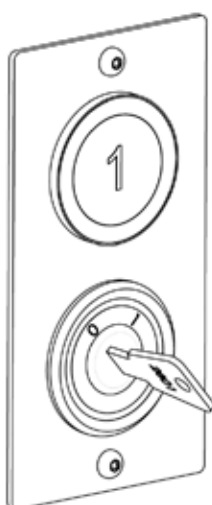

Abilitation Key and Push Button

Door

External door control – placed away from lift

Door control placed away from the lift in an external call station box connected to the lift via a cable. For the HL100 Compact, when having a door on the B-side, there is no frame and thus no place for a door faceplate. Standard solution is to have the call button in an external call station box connected to the lift via a cable.

Size: 130x70x55 mm without display / 220x95x55 mm with display

Finish: The faceplate is in standard Alluminium. As option it can be delivered RAL painted in the same colour of the box.

Call box can be for Surface or Flush Mounting

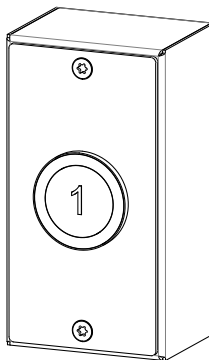

Door handle

One stainless steel handle is provided as a standard content with each landing door.



Call box for flush wall mounting

Recommened dimensions for mounting

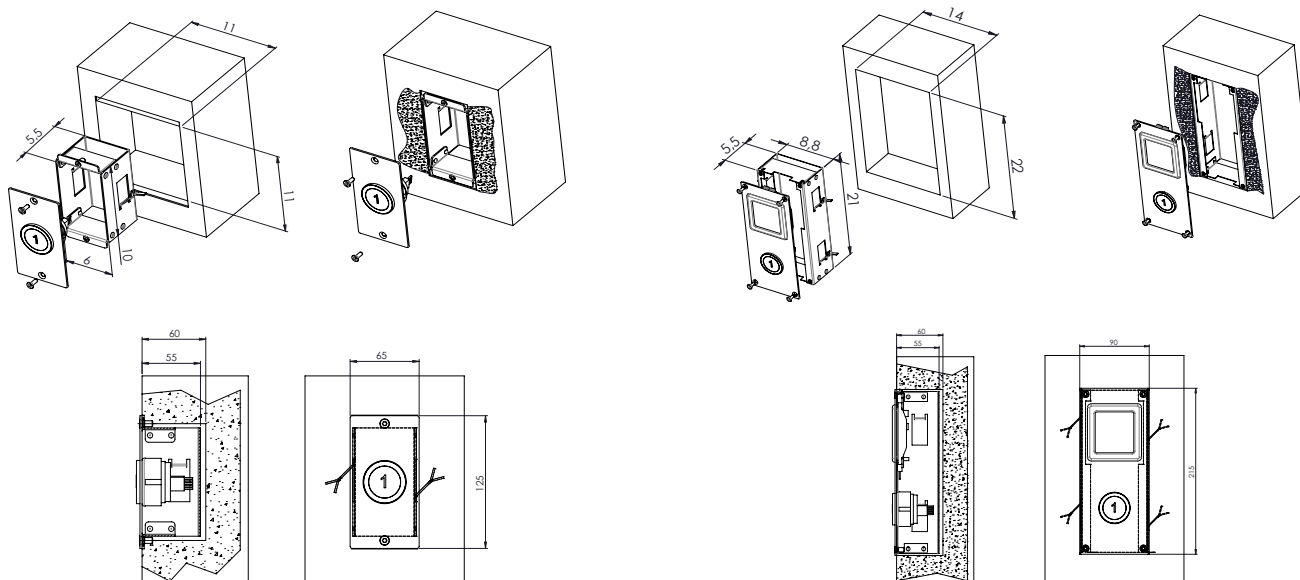

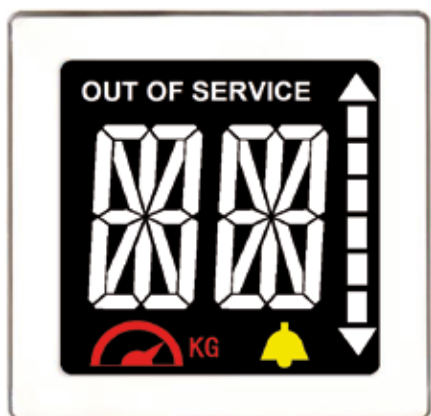

Landing indicator on door

Digital display positioned at the door frame. It shows which floor the lift is on at the moment.

The landing indicator can also show following system information:

- Direction of the lift when travelling
- A bell when the alarm button has been pressed.
- A weight symbol will appear if the lift is overloaded.
- Error code for diagnostic
- Out of service state

Can be ordered as option

Standard doors are semiautomatic which means that they are opened manually and they close automatically.

The closing speed and time cannot be adjusted.

External Door opener - optional

An automatic door opener can be ordered as option. It opens and closes the door automatically. Door open / closing time and speed are adjustable.

Cover always painted white.

When having two doors on the same landing, both doors will be opened at the same time when having door openers.



Internal door closer - optional

An automatic door closer can be ordered as option. It closes the door automatically after a preset time. It is built into the door frame and is invisible from the outside. Includes function to keep door open until the user manually closes the door.



Ramp

If the lift is installed without a pit a ramp is mandatory according to EN81.41.

The ramp is made of aluminium to prevent slipping. The vertical rise of the ramp is less than 1:4. The ramp can be ordered as an option for lifts installed without a pit.

Ramp dimensions: Height 50 mm, width 460 mm, as long as the shaft side where installed.





Shaft

The lift is always delivered with a metallic shaft. The top height of the shaft (distance from top floor to top of shaft) is always 2430 mm. Elongation of the shaft is possible for Mobility. Please consider a free height from building minimum 20 mm for installation purpose. The lift has to be installed always against a wall. The machine side is not cladded. For all sides except for machine side you can choose to have shaft panels in steel or glass.



Inner ceiling

The lift always comes with an inner ceiling, painted in the same colour as the shaft walls. Standard is RAL 9010 (White). If the shaft is painted in another RAL colour the inner ceiling is painted in the same colour.



Shaft panels

Standard is 30 mm thick shaft panels with polyurethane and steel plates. The panels have a classified fire resistance of Bs2d0. The panels have a RAL 9010 finish (white) as standard. If painted in another colour, the shaft structure and shaft panels will be painted in the same colour. The standard height of shaft panel is 1000 mm.

Top Cover plate

Plate to cover the equipment placed at the top of the mast, such as battery operated emergency lowering. Can be ordered as an option.

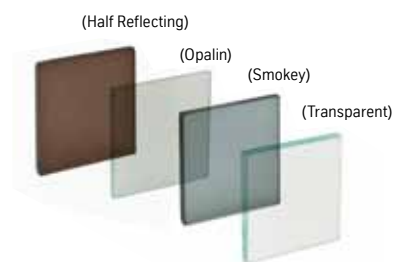

Glass

As an option glass panels with laminated and toughened glass can be ordered. Standard is transparent glass. Option with Smokey Grey, Smokey Satin, Opalin or Half Reflecting. The glass panels are 8/9 mm thick. The glasses are fitted in aluminium profiles. As option the profiles can be delivered RAL painted.

Light Shaft



Configuration for delivery

The lift is delivered with the main parts already assembled to optimize weight and installation time.

Electrical cables are prewired and prepared with connectors

Small parts are packaged into specific identified boxes.

The main screw and the T-guides are "cut at measure" to avoid operations at installation site.

- Screw sections are always in parts with a maximum length of 2900 mm
- T-Guide sections are always in parts with a maximum length of 3000 mm

The lift is always delivered with an optimized package to reduce logistic costs and product breakage during transportation.

Electrical cabinet - Compact

The standard position of the electrical cabinet **is in the shaft**, at the **upper** floor where the landing door is located.

An external service panel is available for mounting outside the lift as a standard. In this case a wire connects it with the service panel in the electrical cabinet.

Electrical cabinet - Mobility

The standard position of the electrical cabinet **is in the shaft**, at the **lower** floor where the landing door is located. A service panel is always accessible from the outer side A/C of the shaft. Side shall be defined at order stage.

Service panel

It is used for maintenance purpose and for emergency running the lift.

For Compact, it is always provided in a separate box for wall mounting.

For Mobility, it is placed as a standard in the electrical cabinet. Can be ordered as option in a separate box for wall mounting. In this case a wire connects it with the service panel in the electrical cabinet.

Size of the separate box: 220x95x57 mm key excluded

Finish: The faceplate is in standard Aluminium. As option it can be delivered RAL painted in the same colour of the box.

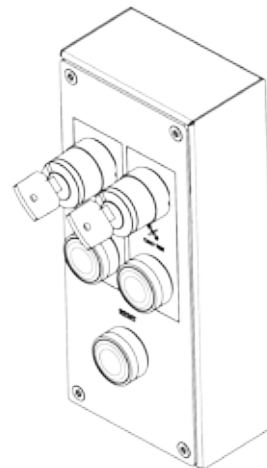

Communication

Two way communication is mandatory according to EN81-41. Choose from one of the following options or install your own phone.

Autodialer

Equipment for emergency calls. Integrated on the control operation panel. Dials automatically when the alarm button is kept pressed for 3 seconds.

When unanswered after a predefined time, the call is automatically forwarded to the next number.

The autodialer can be equipped with a GSM module.

Phone

The telephone works as a standard telephone but is intended for emergency calls. The phone is mounted on the platform panel.



Drive - valuable standard features



Battery operated emergency lowering

Battery operated emergency lowering is a standard feature in every lift.

You can lower yourself from inside the lift and get out by yourself when there is a power failure. Possible to run the lift to nearest lower level from the platform. Executed when pressing a destination button. Can also be run externally from the call button (hold to run) or service box..

The embedded **battery guard** ensures that the batteries are not damaged and that there is enough power so that you can run the lift in the case where the power to the lift is cut. It ensures that the lift is turned off (all power consumers are turned off) when the power of the batteries reaches a predefined level.

Automatic Lubrication

As a standard every lift is provided of an automatic lubrication device, which oils the driving screw regularly.

Soft start and stop.

It provides a smooth start and stop of the lift.

It comes as a standard featured for all the lift of our series

FAQ

1. Can I have the lift painted in any colour?

The HL100 can be painted in any RAL colour
Following choices are available:

Whole lift in standard colour RAL 9010 (White)

- Whole lift painted in RAL 9010 and Platform Wall in skinplate A4

Lift elements painted in different colours:

- Shaft, Shaft Panels painted in one colour
- All doors and call stations/faceplates painted in one colour.
- Platform Wall in skinplate or stainless steel or painted in one colour.
- Platform Wall in one finish and accent for central panel (skinplate or stainless steel).
- One of the above choices or a combination of them.

Note that all doors must be painted in the same way. It is not possible to paint them differently.

Painting for Shaft, Doors, Platform Walls is powder coating with orange peel finish (grade coarse), gloss 80-90 (i.e. it is a gloss colour).

Shaft Panels have gloss painting on smooth surface.

Any RAL colour means in this case any RAL color from the 213 colour RAL chart K7 classic.
Typical Colours from the side table are provided with shorter lead time and lower price.
Metallic colours are not possible.

All parts can show small colour differences, this is normal and unavoidable.
While we take every precaution to minimize visible differences, this cannot be guaranteed.



Typical Colours

RAL	Skinplate
RAL 9003	A1; PPS10
RAL 9010	A4
RAL 1013	A13; PPS11
RAL 1015	G1
RAL 5024	B13
RAL 7035	N1; PPS1
RAL 7037	Metal Like



2. To which standards do the lifts comply?:

The HL100 comply with the Machine Directive 2006/42/EC, by following the harmonized standard EN 81-41.
The lifts are also compliant with the Electromagnetic Compatibility Directive EMC 2014/30/EU and Low voltage Directive 2014/35/EU.
EI120 – Fire & smoke proof door complies with the EN 81-58 according to the Lift directive 95/16/EC.
The lifts are type approved, CE marked. A certificate for respective lift is available on partner desktop.

3. What are the reaction forces on the building and force on fixings to support frame to wall?

Details regarding the forces are available in the pre-installation manual

Reaction forces from the lift to the building floor:

Maximum force as a function of the lift's travel.

The force is distributed to the floor through the area "P" and the area "S".
The platform apply to the pit on the Area "P" a Force function of the travel and the model.

The shaft apply to the shaft base a force function of the travel, model and panels.

The force is applied on the perimeter of the shaft according to the standard plan.

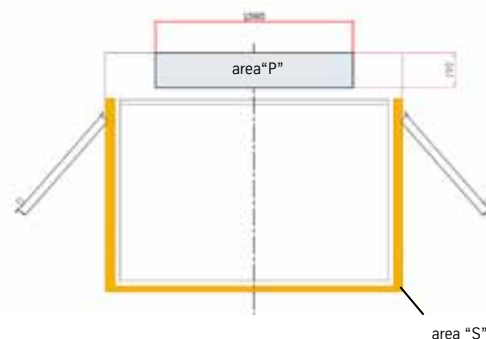

Load from the lift to Drive area "P"

Travel (m)	"Compact" Load (kN)	"Mobility" Load (kN)
2	5,9	9,4
3	6,1	9,6
4	6,3	9,8
5	6,5	10,0
6	6,7	10,2
7	6,9	10,4
8	7,1	10,6
9	7,3	10,8
10	7,5	11,0
11	7,7	11,2
12	7,9	11,4

Load from the lift to Shaft area "S"

Travel (m)	Compact - Load (kN)		Mobility - Load (kN)	
	Panel	Glass	Panel	Glass
2	2,9	4,4	3,3	5,3
3	3,5	5,4	4,1	6,4
4	4,1	6,4	4,8	7,6
5	4,8	7,4	5,5	8,8
6	5,4	8,3	6,3	10,0
7	6,0	9,3	7,0	11,1
8	6,7	10,3	7,8	12,3
9	7,3	11,3	8,5	13,5
10	7,9	12,3	9,2	14,6
11	8,6	13,3	10,0	15,8
12	9,2	14,2	10,7	17,0

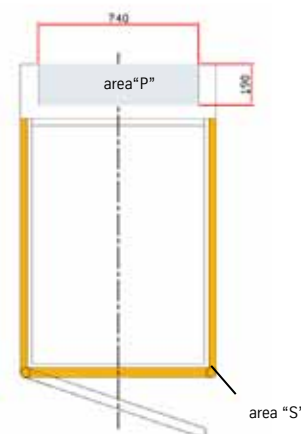

Reaction Force on the wall (rail side):

The force is distributed to the wall through each crossbeam.

Vertical distance between each crossbeam is on average 1,1 meter

Maximum force applied to each fixing point as a function of the lift's rated load.



Model	Rated load [kg]	Reaction Force Fx [N]
HL100 Compact	250	550
HL100 Mobility	325	700
HL100 Mobility	400	950

Features & Benefits



Features and benefits

You can always get out of the lift by yourself

If there is a power failure, you can always get out of the lift by yourself with battery operated emergency lowering. Use the platform buttons and the lift will take you to the closest lower floor and you can open the door and get out by yourself.

The safest screw lift of its kind

For safety we prefer to count on more than one system. The overspeed governor and brake is separated from the main drive system. The electronics is certified from third party with the highest Safety Integration Level for units of its kind.

Minimum builders work and small footprint

The lift can be installed without a pit, with a ramp or with a 50 mm pit without ramp.
All parts are included in the shaft - no extra machine room or head room needed.

Easy installation

Means that the lift is both easy and fast to install. A normal installation only takes two days.

No need for a machine room

Traction machine is travelling with the cabin.
Electrical board installed in the shaft.
No additional space / cabinet needed.

Low operation and maintenance cost

Lowest on the market. Remote diagnostic system available as option.

Compact and robust shaft

30 mm shaft panels. Robust and resistant to damage.
Good noise and acoustical isolation.

Power Management System (PMS)

The first lift in the market provided with an intelligent system adjusting the absorbed power to the installed power in the building.

Drawings

Typical layout & Plan sizes





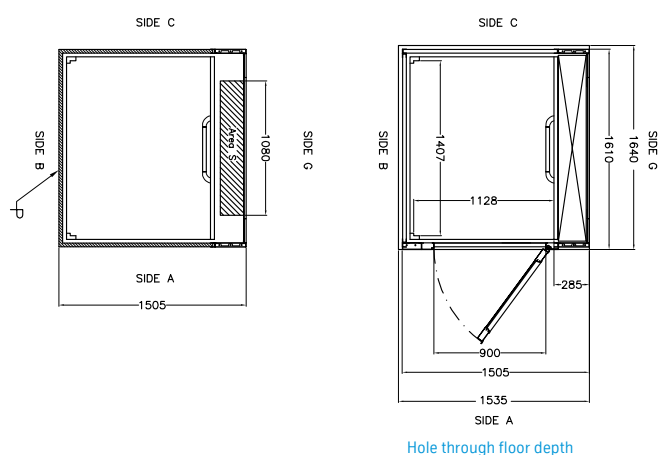
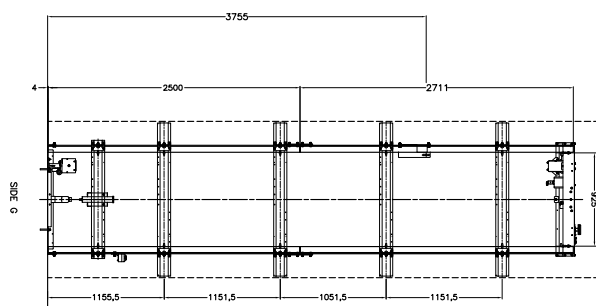
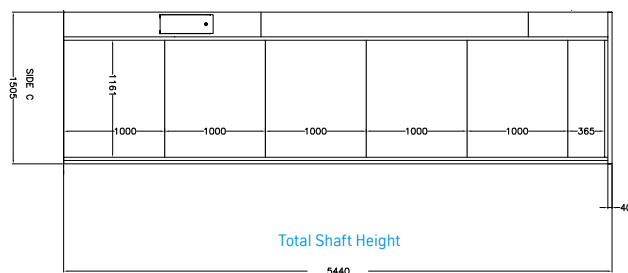
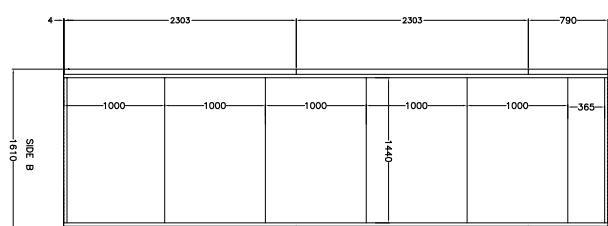
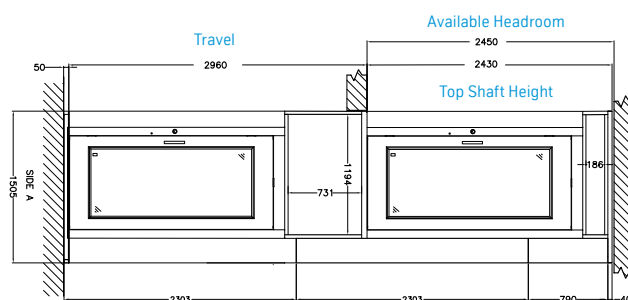

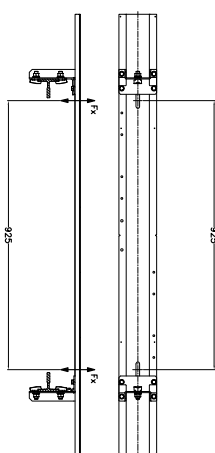

This section illustrates shaft and platform dimensions according to the different car and accesses configurations. Also possible side for door placement is visualized.

Typical Layout

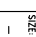
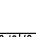
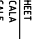
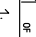
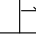

Area S	
Travel (m)	Load (kN)
2,96	10,3
Shaft Load (kN)	
B	3,5
Reaction forces (N)	
F _x	950

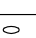

Maximum Load: 400 Kg	
Max rated speed: 0,15 m/s	
Drive mechanism: Spindle	
Landing operation: Manual	
Current frequency: 50/60 Hz	
Power supply: 1-Phase circuit breaker 230 V 16 A tripping curves C—RDC 30 mA A or B class	
Max. power:	
DO NOT EXCEED MAXIMUMS IN LISTED LINE DIMENSIONS AND TOLERANCES UNLESS SPECIFICALLY NOTED OTHERWISE UNLESS INDICATED OTHERWISE TO THE CONTRACTOR'S ADVANTAGE	
	PREPARED TO ORDER SHEET 1 OF 1 SCALE 1:-- SCALE 1:--
	PREPARED TO ORDER SHEET 1 OF 1 SCALE 1:-- SCALE 1:--
	PREPARED TO ORDER SHEET 1 OF 1 SCALE 1:-- SCALE 1:--
	PREPARED TO ORDER SHEET 1 OF 1 SCALE 1:-- SCALE 1:--
	PREPARED TO ORDER SHEET 1 OF 1 SCALE 1:-- SCALE 1:--
	PREPARED TO ORDER SHEET 1 OF 1 SCALE 1:-- SCALE 1:--
	PREPARED TO ORDER SHEET 1 OF 1 SCALE 1:-- SCALE 1:--
	PREPARED TO ORDER SHEET 1 OF 1 SCALE 1:-- SCALE 1:--
	PREPARED TO ORDER SHEET 1 OF 1 SCALE 1:-- SCALE 1:--
	PREPARED TO ORDER SHEET 1 OF 1 SCALE 1:-- SCALE 1:--
	PREPARED TO ORDER SHEET 1 OF 1 SCALE 1:-- SCALE 1:--
	PREPARED TO ORDER SHEET 1 OF 1 SCALE 1:-- SCALE 1:--
	PREPARED TO ORDER SHEET 1 OF 1 SCALE 1:-- SCALE 1:--



Compact - Full Panel

800x580

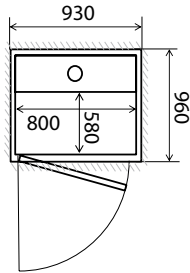

Hole through floor: 930x960 mm
Platform: 800x580 mm
Doors: 800 mm
Load: 250 kg

800x840

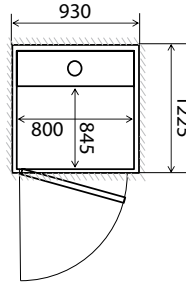

Hole through floor: 930x1225 mm
Platform: 800x845 mm
Doors: 800 mm
Load: 250 kg

800x1100

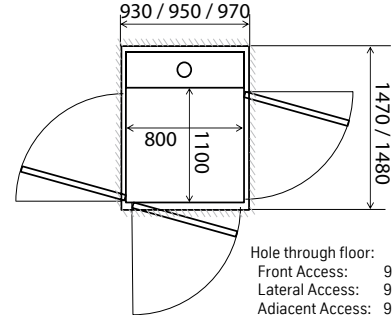

Hole through floor:
Front Access: 930x1480 mm
Lateral Access: 950x1470 mm
Adjacent Access: 950x1480 mm
Opposite Access: 970x1470 mm
Platform: 800x1100 mm
Doors: 800 mm
Load: 250 kg



Mobility - Full Panel with Roof

1400x900

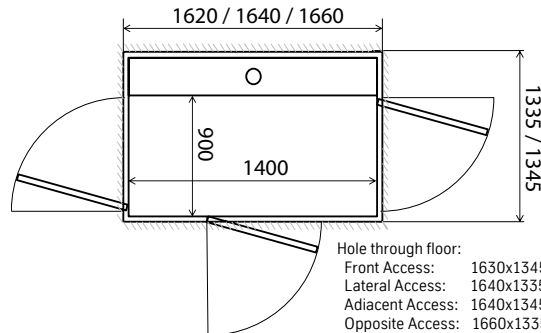

Hole through floor:
Front Access: 1630x1345 mm
Lateral Access: 1640x1335 mm
Adjacent Access: 1640x1345 mm
Opposite Access: 1660x1335 mm
Platform: 1400x900 mm
Doors: 900 mm B-side / 700 mm A/C-side
Load: 325 kg

1400x1000

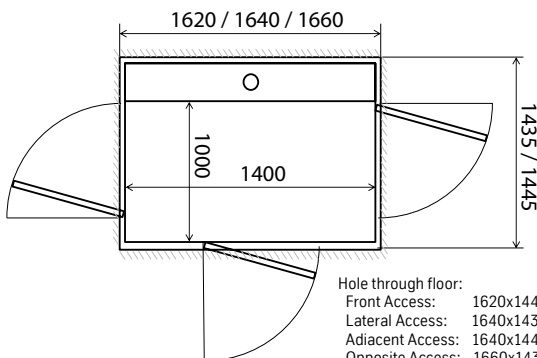

Hole through floor:
Front Access: 1620x1445 mm
Lateral Access: 1640x1435 mm
Adjacent Access: 1640x1445 mm
Opposite Access: 1660x1435 mm
Platform: 1400x900 mm
Doors: 900 mm B-side / 800 mm A/C-side
Load: 325 kg

1400x1100

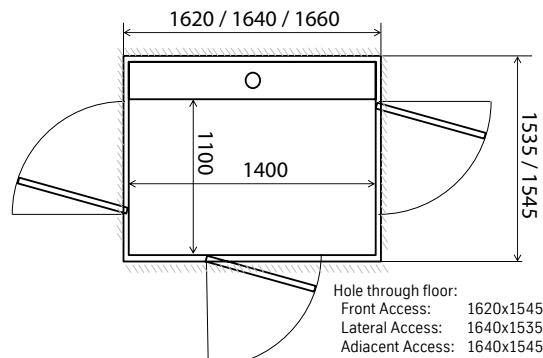

Hole through floor:
Front Access: 1620x1545 mm
Lateral Access: 1640x1535 mm
Adjacent Access: 1640x1545 mm
Opposite Access: 1660x1535 mm
Platform: 1400x1100 mm
Doors: 900 mm A/B/C-side
Load: 400 kg

Compact - Full Panel - 800x580 - Front

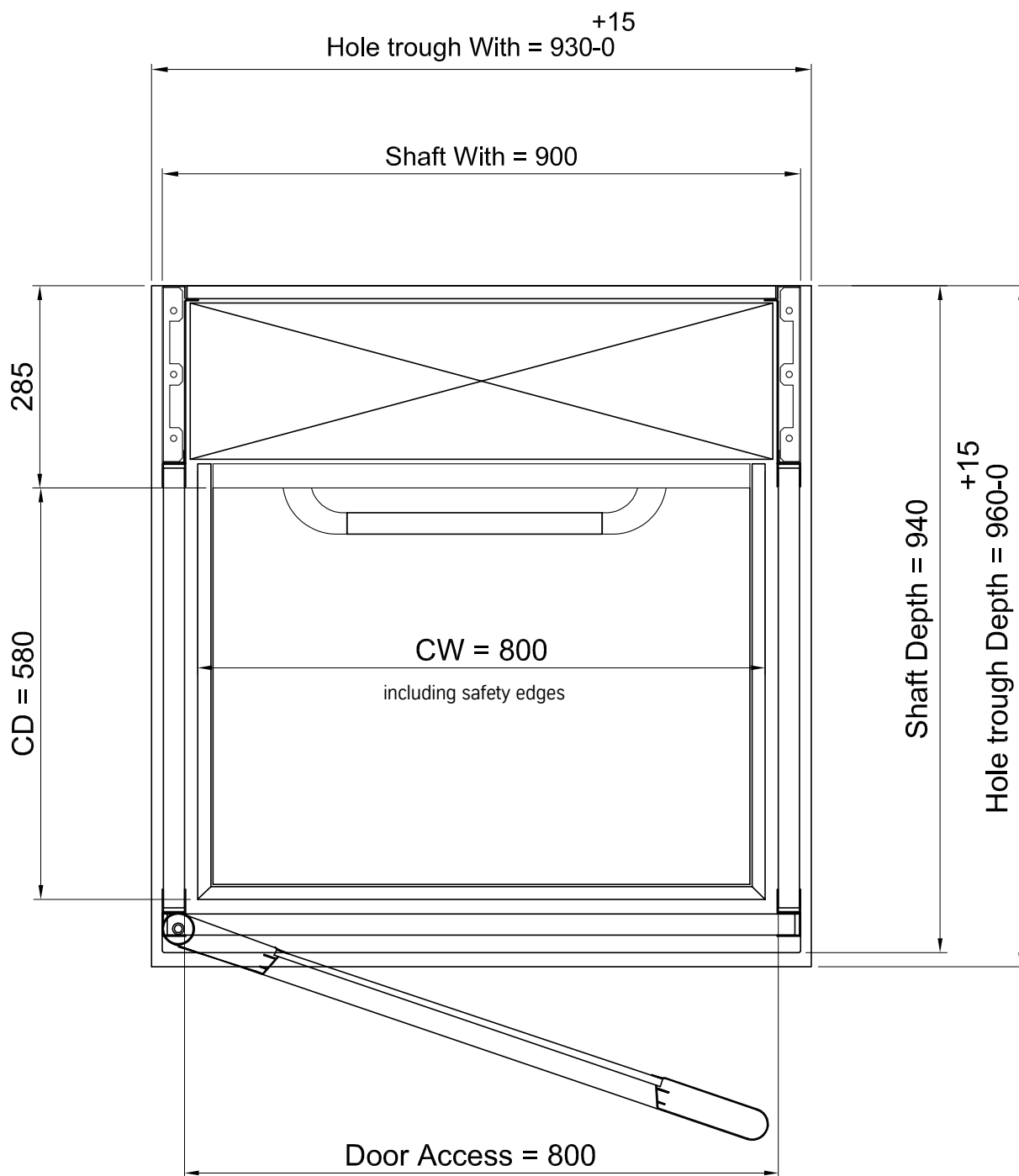

Compact - Full Panel - 800x840 - Front

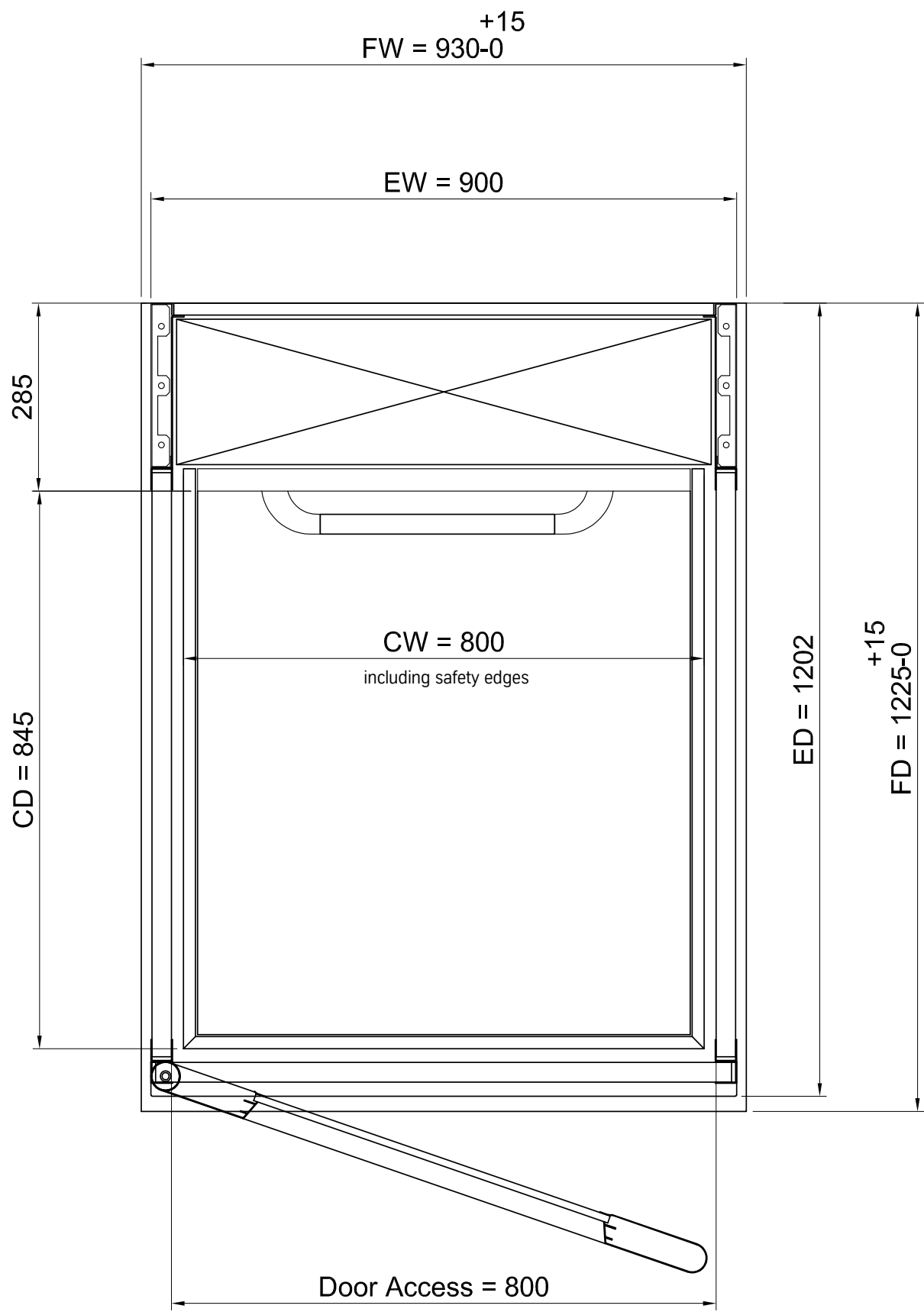

Compact - Full Panel - 800x1100 - Front

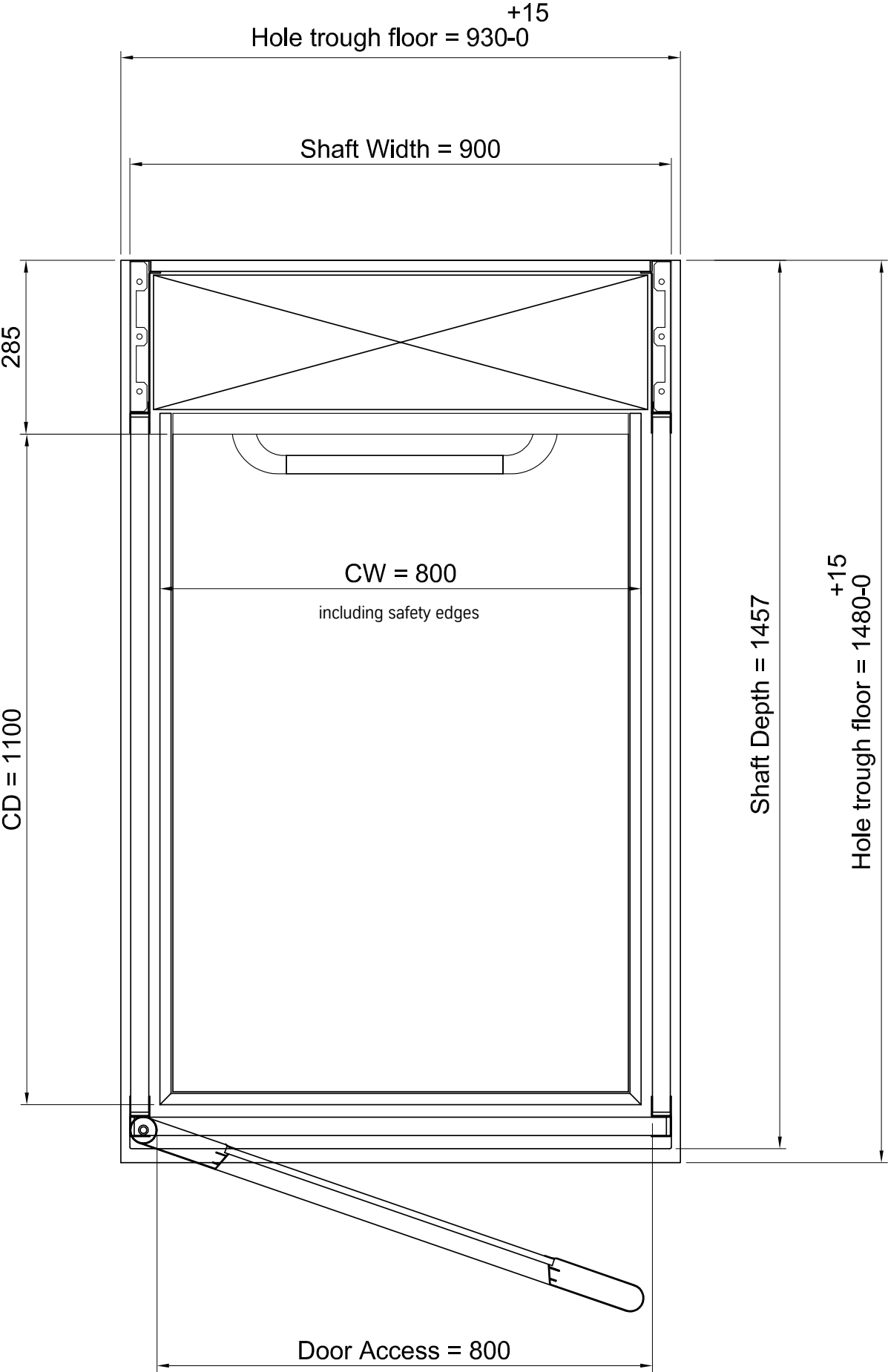

Compact - Full Panel - 800x1100 - Opposite

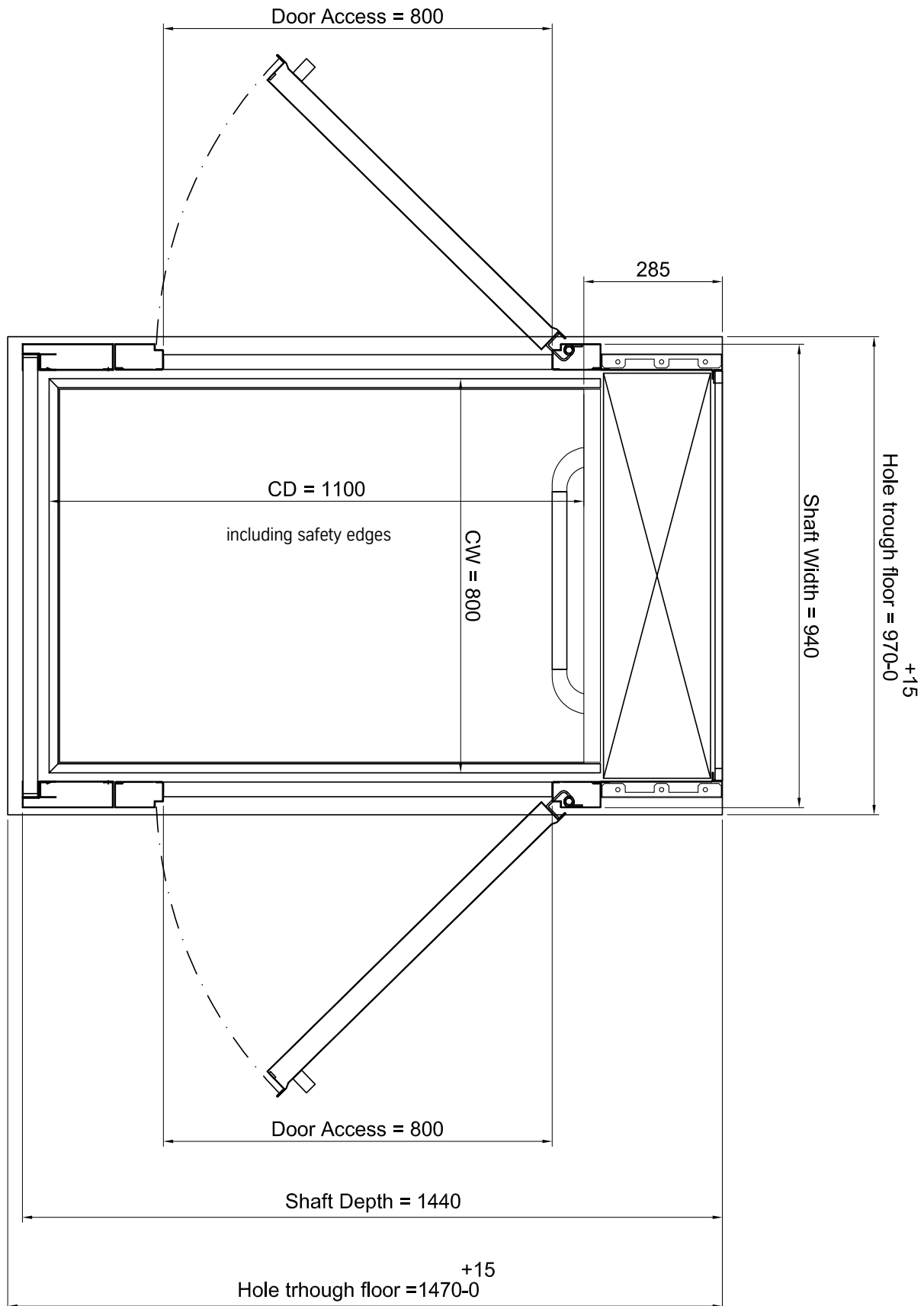

Compact - Full Panel - 800x1100 - Lateral

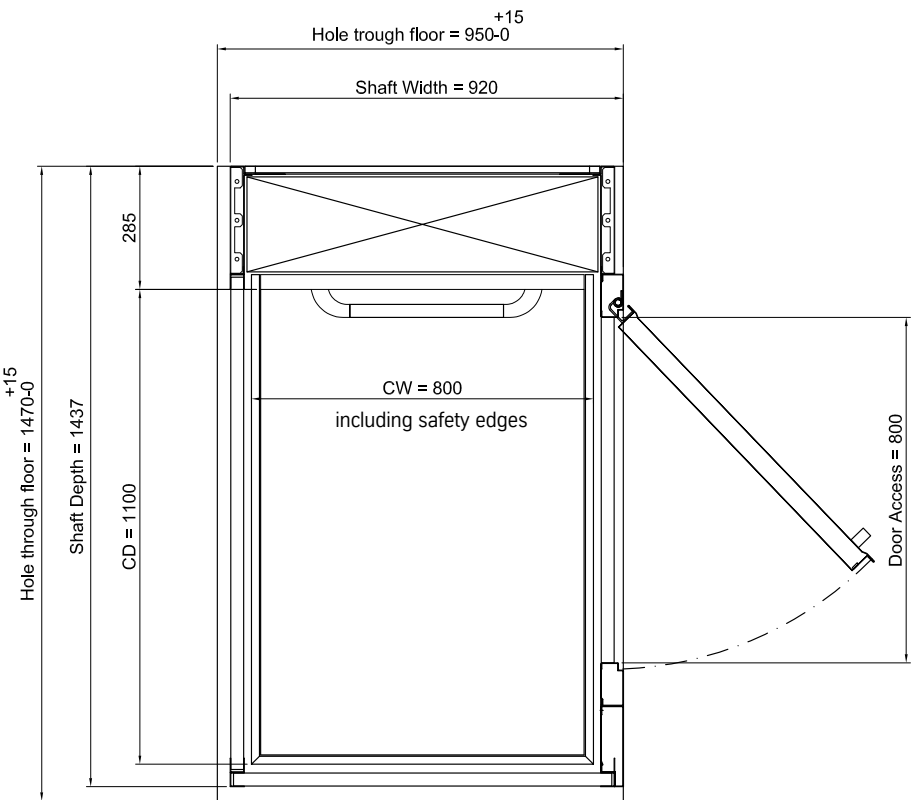
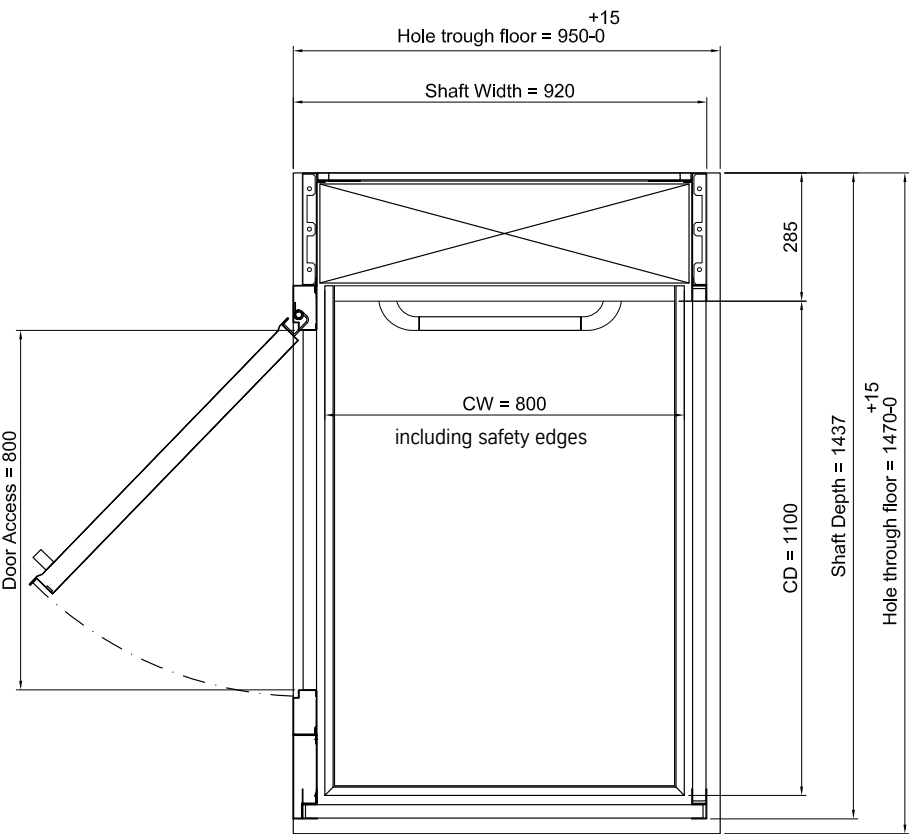

Compact - Full Panel - 800x1100 - Adjacent

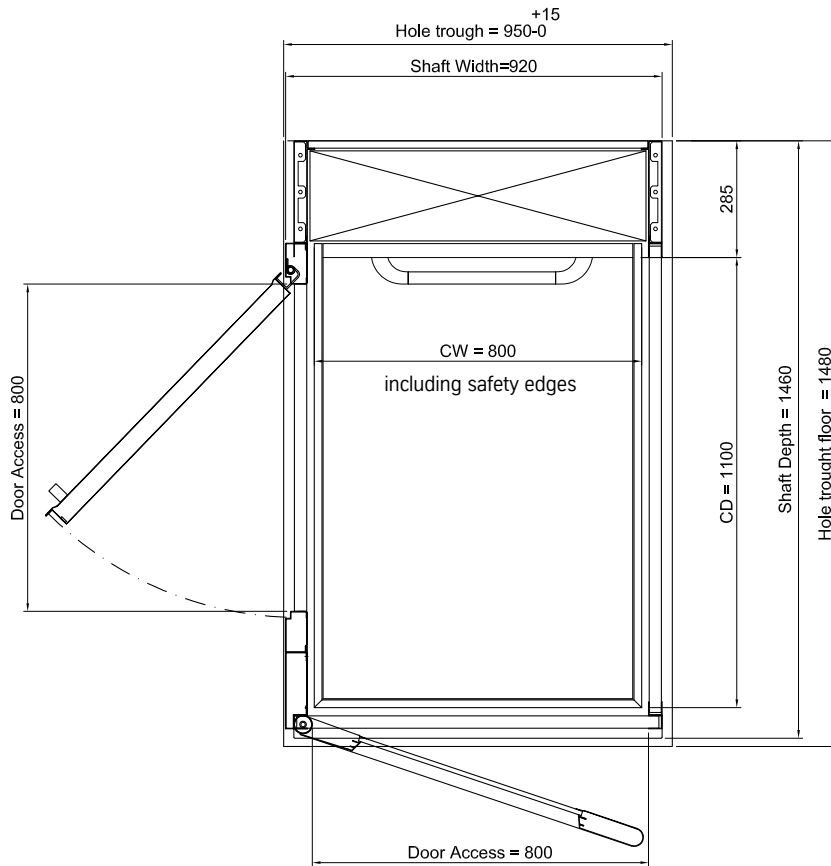

Adjacent accesseres are possible with doors at different floors with minimum distance between floors 2300 mm

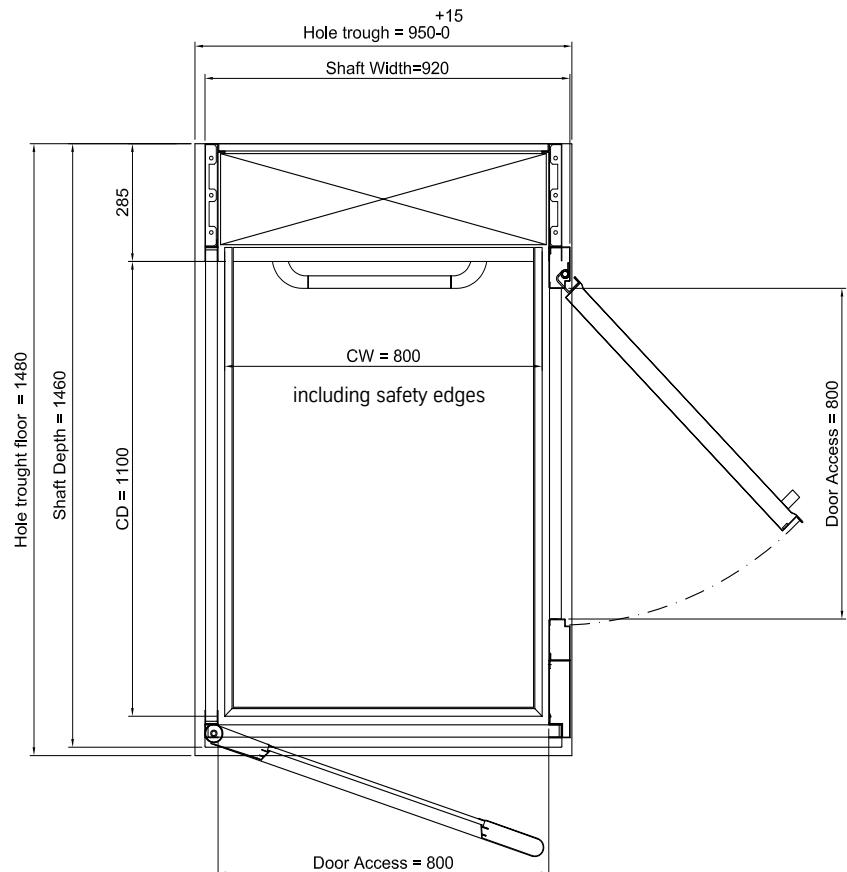

Mobility - Full Panel Roof - 1400x900

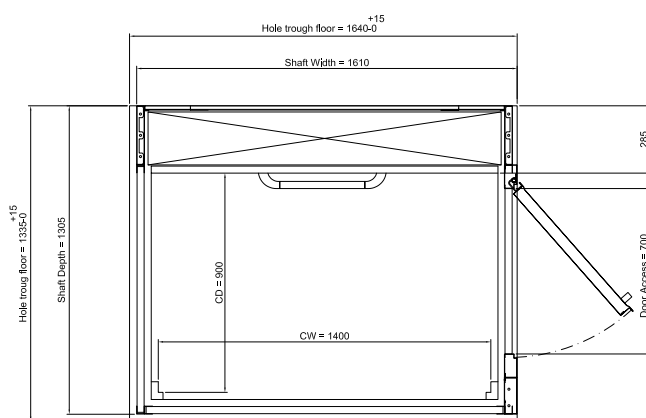
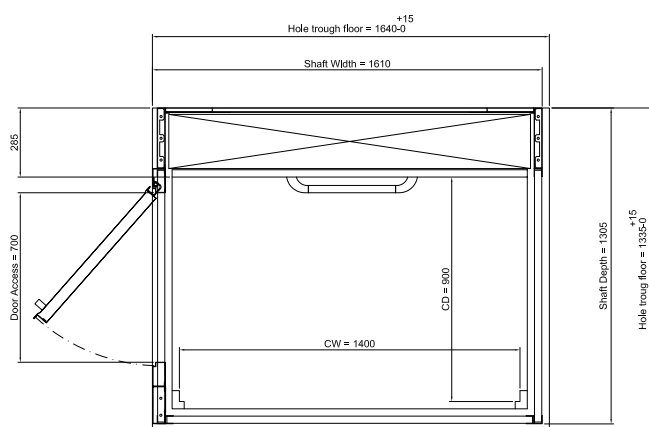
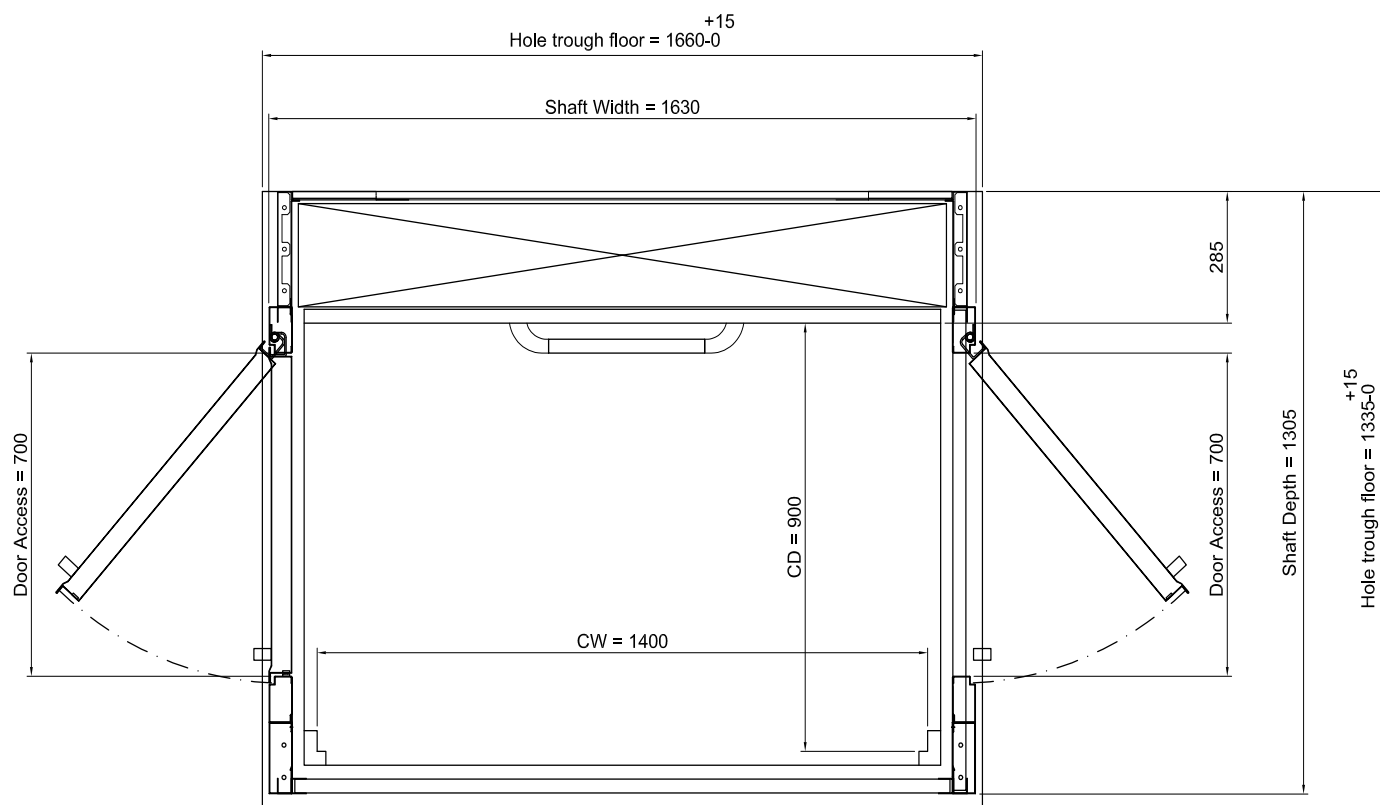

Mobility - Full Panel Roof - 1400x900

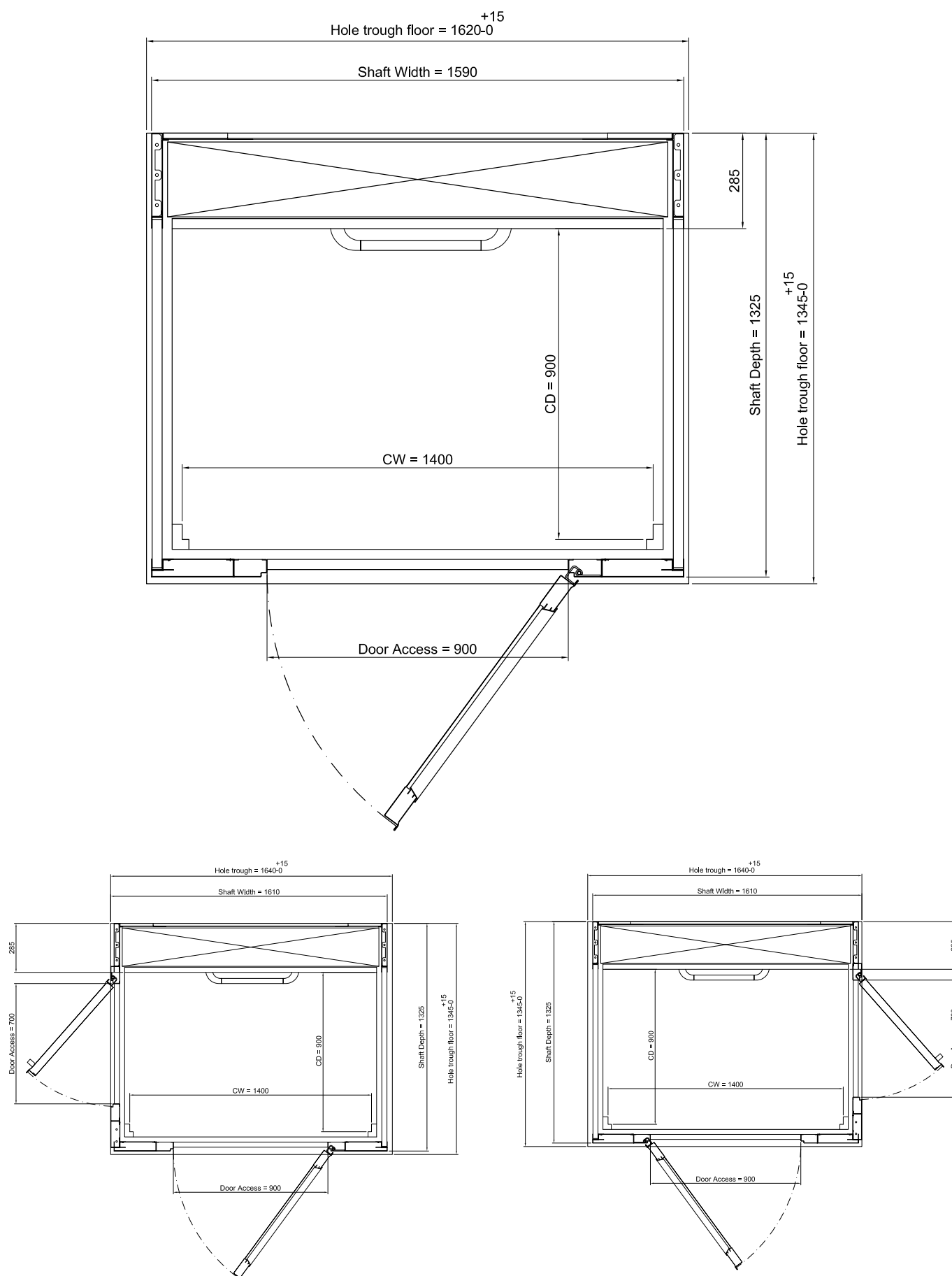

Mobility - Full Panel Roof - 1400x1000

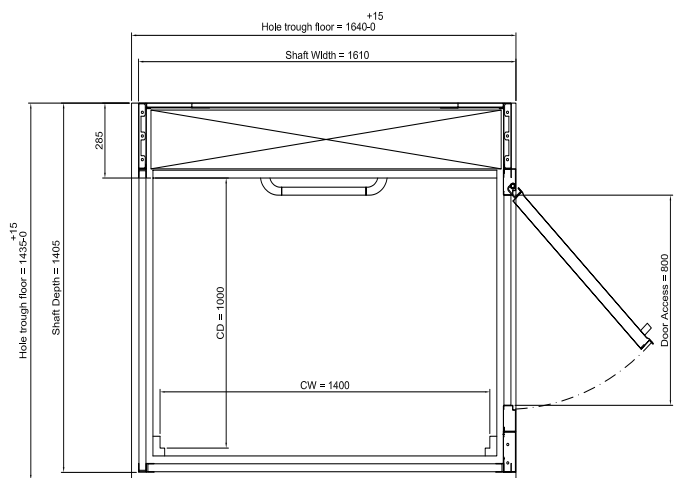
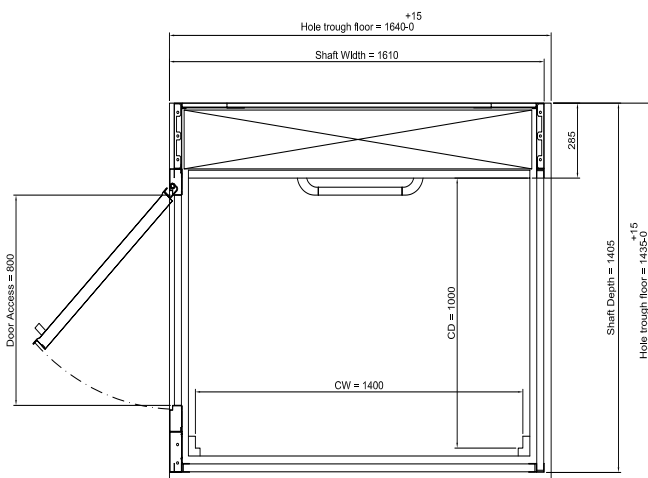
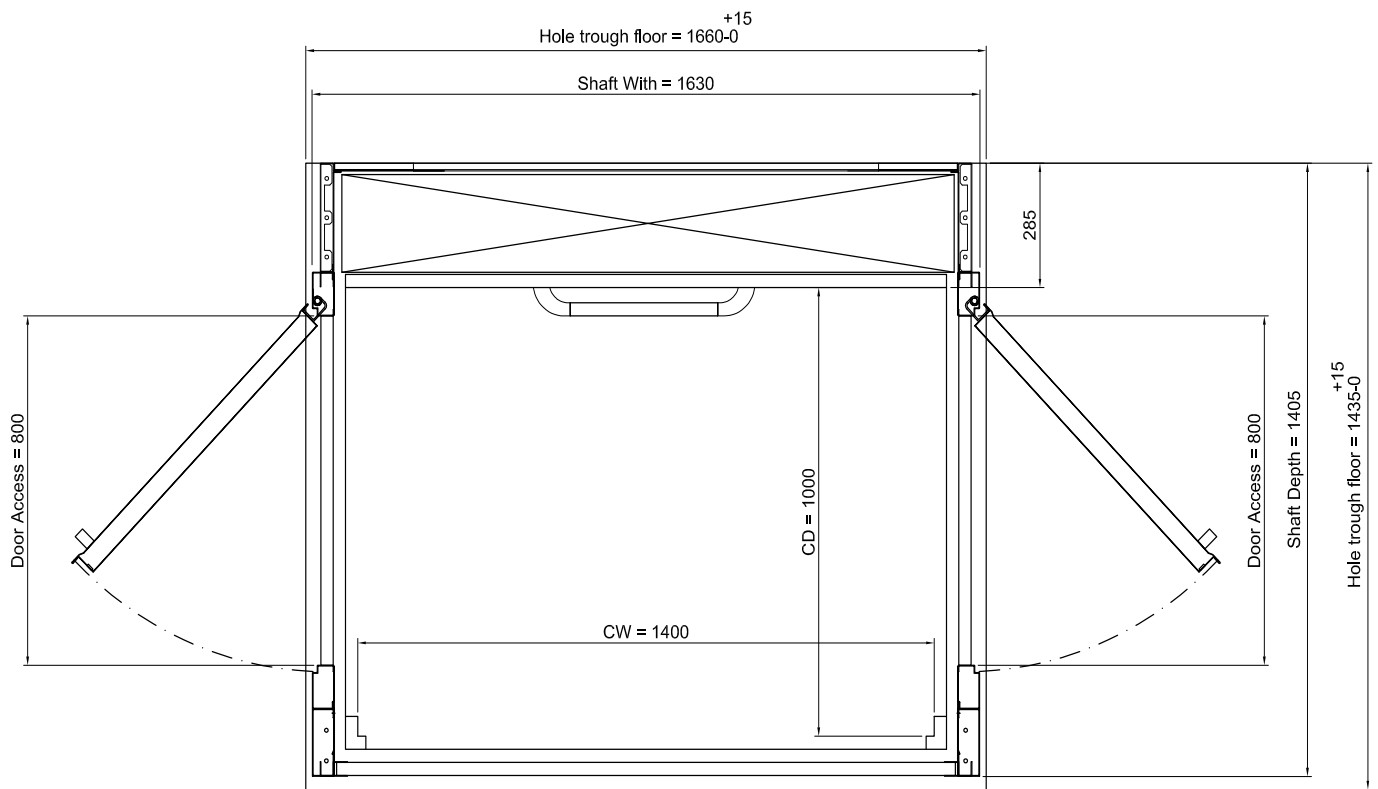

Mobility - Full Panel Roof - 1400x1000

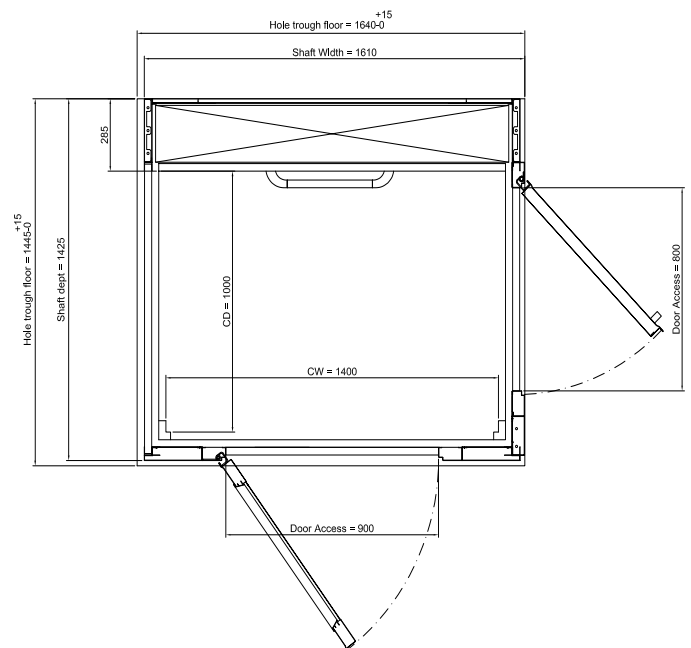
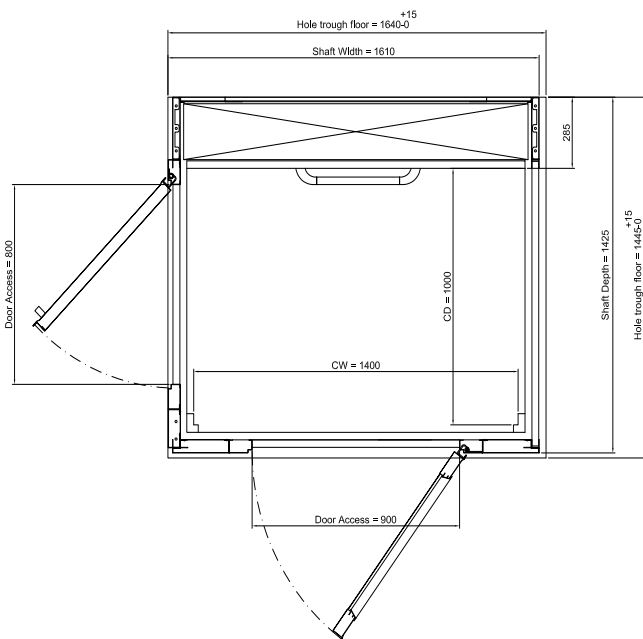
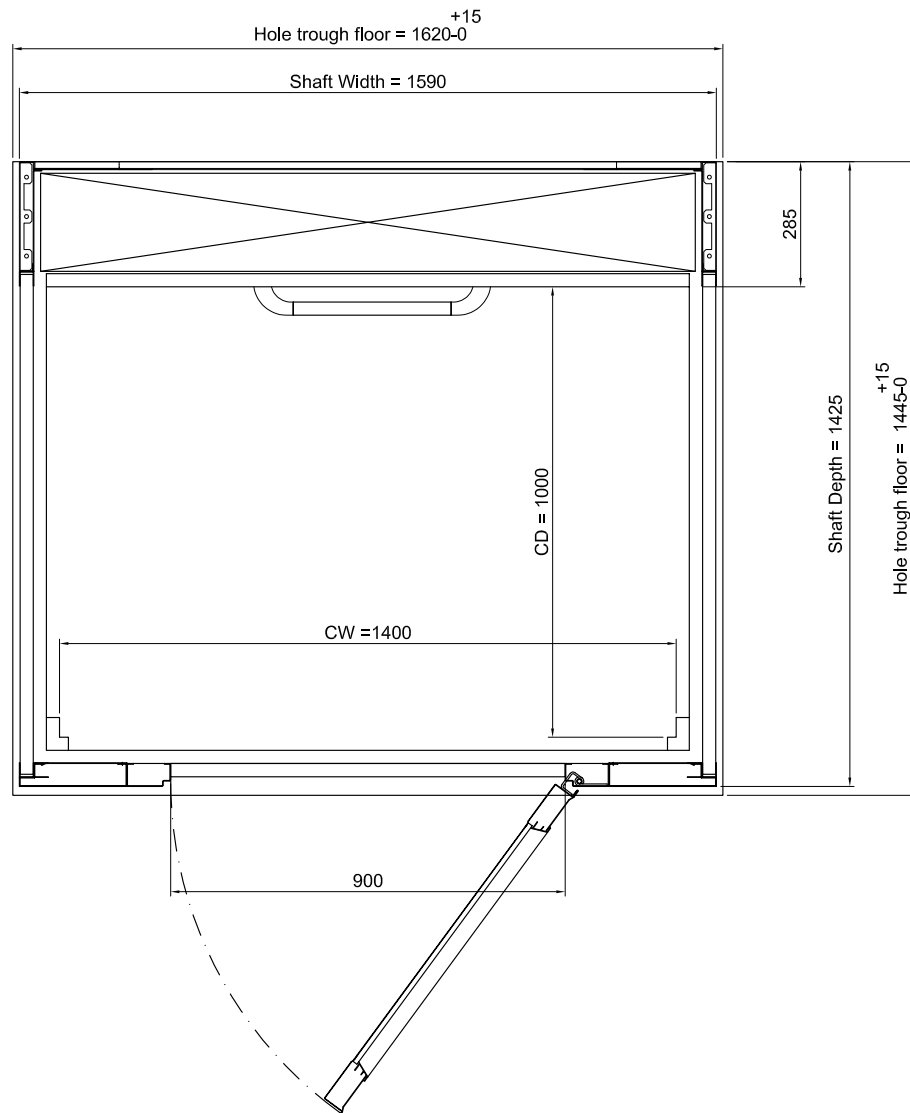

Mobility - Full Panel Roof - 1400x1100

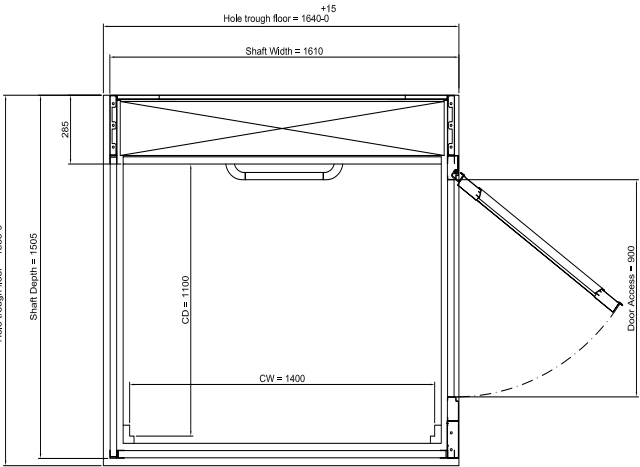
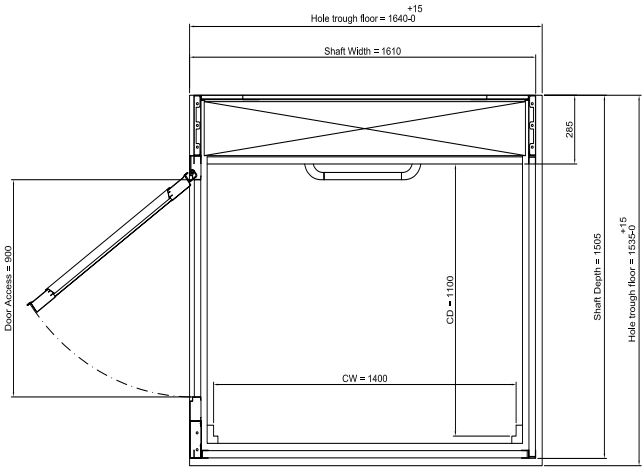
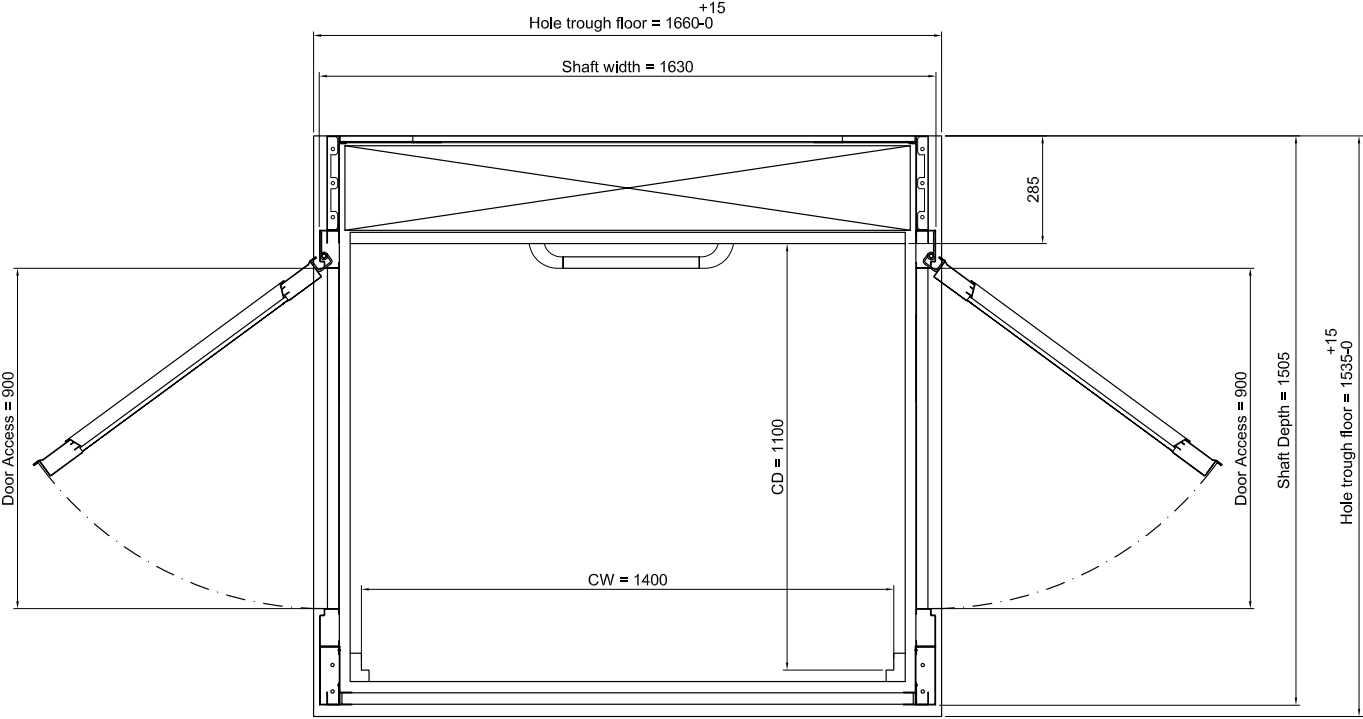

Mobility - Full Panel Roof - 1400x1100

